

# Shunt Series

## Shunt-2000A

DC Current Shunt Datasheet



Accuenergy DC current shunts are engineered for precision measurement in DC current systems. Designed to connect to a DC power meter to measure electrical currents based on a small voltage drop, DC current shunts provide accurate energy measurements in a variety of applications including renewable energy, mass transit, battery charging, electric vehicles, welding, heavy industrial environments, and OEM applications.

### Features

- Accuracy class: 0.5%
- 75mV voltage drop



### Accuenergy Inc.

Los Angeles - Toronto - Pretoria  
 North America Toll Free: 1-877-721-8908  
 Web: [www.accuenergy.com](http://www.accuenergy.com)  
 Email: [marketing@accuenergy.com](mailto:marketing@accuenergy.com)

Revision Date: August 2024 Version: 1.0.3  
 Specs Subject To Change Without Notice.



### Specifications

|                      |                          |
|----------------------|--------------------------|
| <b>RATED CURRENT</b> | 2000A                    |
| Current Range        | 10-120% of rated current |
| Accuracy             | 0.5%                     |
| Voltage Drop         | 75mV                     |

### MECHANICAL/ENVIRONMENTAL

|                                   |                                                                                   |
|-----------------------------------|-----------------------------------------------------------------------------------|
| Form Factor                       | Inline installation                                                               |
| Exterior Dimensions               | 245.0mm x 130.0mm x 100.0mm<br>9.64" x 5.12" x 3.94"                              |
| Case Material                     | Manganin Alloy                                                                    |
| Operating Temperature             | -40°C to 80°C / -40°F to 176°F                                                    |
| Shunt Temperature w/ Load Current | <80% of rated current = 80°C (176°F),<br>>120% = of rated current = 120°C (248°F) |
| Storage Temperature               | -55°C to 85°C / -67°F to 185°F                                                    |
| Operating Humidity                | Non-condensing, 0 to 95% RH                                                       |
| Installation Conditions           | Indoor Use                                                                        |

### ELECTRICAL

|                 |    |
|-----------------|----|
| Frequency Range | DC |
|-----------------|----|

### SAFETY/COMPLIANCE

|                |                                   |
|----------------|-----------------------------------|
| Overload       | 120% of nominal current (2 hours) |
| Certifications | RoHS                              |

### Dimensions

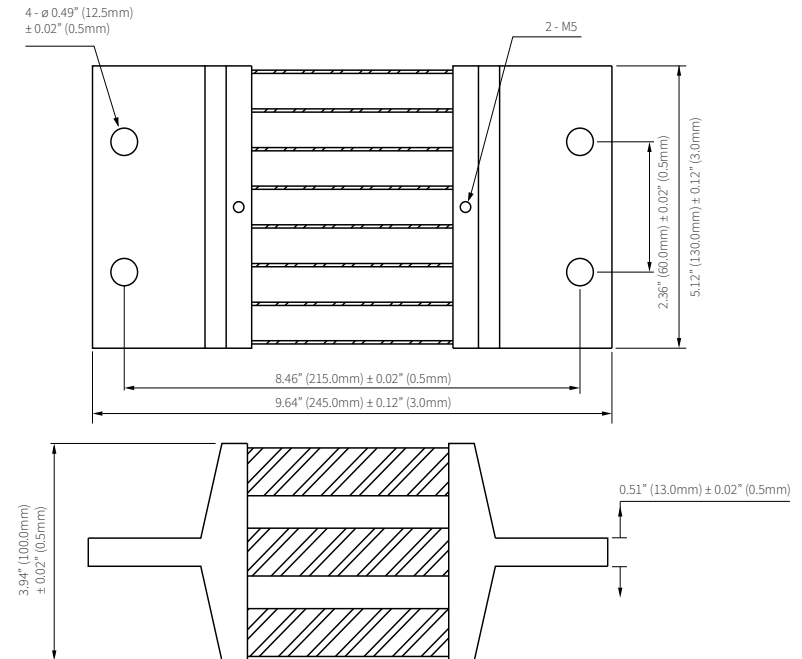

### Ordering Information

|                         |              | Rated Input    | Voltage Drop  |
|-------------------------|--------------|----------------|---------------|
| <b>Ordering Number</b>  | Shunt        | -              | /             |
| <b>Ordering Example</b> | <b>Shunt</b> | <b>- 2000A</b> | <b>/ 75mV</b> |
|                         |              | 2000A          | 75mV          |